

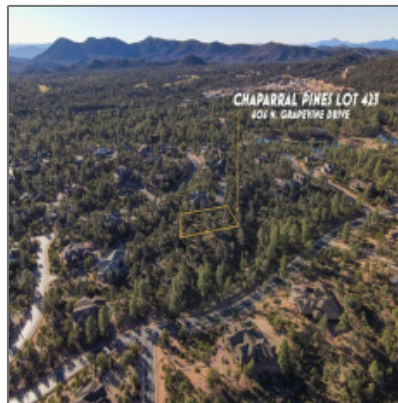

**AZ JOSH**

606 Grapevine Drive,  
Payson, Arizona 85541

- 606 Grapevine Drive, Payson, Arizona 85541



### Property [details](#)

Timestamp: **01.09.2025  
17:27:15**

Property Sub-Type: **Residential**

Status: **Active**

Assessments: **0.00**

Area: **Payson Northeast**

Direction: **N**

Lot Dimensions: **210.64x127.83x246.39**

Zoning: **Residential**

Taxes: **475.00**

Tax Year: **2024**

Waterfront: **No**

### Utilities / [Green Energy Detai](#)

Utilities Available: **Cable  
Tv/satellite,electricity,internet Hook  
Up,piped  
Propane,sewer  
Available,telephone  
,town Of Payson  
Water**

View: **Yes**

Foreclosure: **No**

Short Sale: **No**

HOA: **Yes**

List Type: **Exclusive Ars**

Exterior Features: N/A - Other: **Extra Water Storage**

Exterior Features: **Panoramic View,view Of Mountains,view Of Wooded/trees**

Property Features: **Partially Fenced**

### Neighborhood / [Community](#)

Neighborhood / Subdivision: **Chaparral Pines**

Country: **US**

State: **AZ**

City: **Payson**

Zipcode: **85541**

### Other

Horses: **No**

### Listing [provided by](#)

Office name: **Hughes Realty & Investments**

Listing agent name: **April G Hughes**

MLS #: **91468**

### Agent [Info](#)



Josh Meacham  
☎ 928-268-0567  
✉ [josh@azjosh.com](mailto:josh@azjosh.com)

*928.940.0177 - 600 E, AZ-260 # 7, Payson, AZ 85541*

---

**AZ Josh Meacham Realtor**